

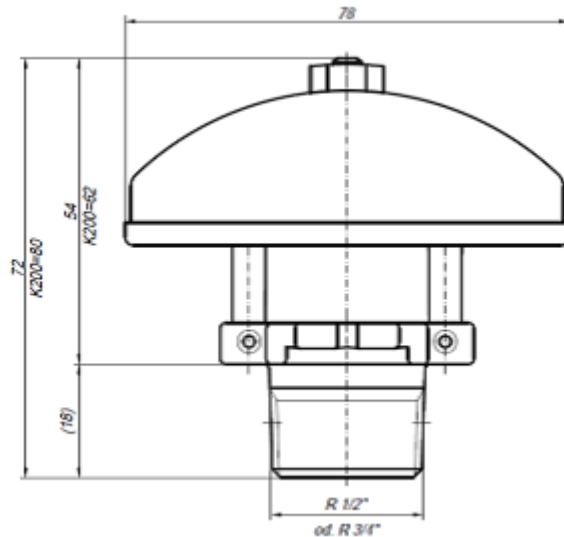

Low Expansion Foam Nozzle Type: SB-FP



Technical Specs

Spray characteristics	Flatspray FP, pendent
Max. working pressure	12.5 bar
Min. working pressure	0.35 bar
K- Factor	SB-FP K80, K115
Protection area K80	Max. 12.25 m ²
Protection area K115	Max. 9 m ²
Foam expansion rate	app. 6-Times (Depending on foaming agent, K-factor and pressure)
Foaming agent	All firefighting foam agents of Dr.Sthamer, other foam concentrates on request

Material / Coatings

Sprinkler body /Deflector	Brass or stainless steel
Foaming creator	Stainless steel
Button	Brass or stainless steel
Sealing Assembly	Stainless steel / Teflon
Pins	Stainless steel

Installation Instruction

- Sprinkler shall only be installed by trained personal.
- Install sprinklers only with the special wrench foreseen for each sprinkler type.
- Install sprinklers only in fully installed and fixed pipe work.
- The threads (fitting / socket) must be clean, free of grease and burrs.

Never install a sprinkler that has had their packaging damaged.

Never install a sprinkler that has been dropped or has suffered any impact.

Always to align sprinklers turn clockwise only. Alignment on the opposite side can create leakage.

Warning

- Sprinklers containing the original packing have been manufactured and tested according the requirements of the sprinkler authorities.
- Any modification of the sprinkler in the form of painting, wrap of deflector, will seriously affect the operation. This will lead to withdraw of insurances approval and any guarantee of EuroSprinkler AG
- Sprinklers (brass and chrome plated) may only installed in normal atmosphere. For areas with aggressive, corrosive atmosphere use sprinklers with special coating or stainless steel sprinklers.

Foam Sprinkler marking

Week of manufacturing **35**= Week 35
Year of manufacturing **09**= Year 2009
Sprinkler size $\frac{3}{4}$ "
K- Factor K200
Certificated at **Vds**

18.03.2021 ast

